

LectraHeat - Mica Band Heater

ID _____
 Width _____
 Watts _____ (Per Section)
 Volts _____ (Per Section)

- 3 Phase
- Dual Voltage
- Dual Circuit - Specify W/V per circuit:

Construction

- One-Piece
- Two-Piece
- Other: _____

- Hinged
- Full Stainless Steel Sheath
- Expandable
- Fully Expandable
- Internal Band (6" minimum OD)
- Partial Coverage - Specify Inside Circumference: _____

Clamping

- Loose Strap with Barrel Nuts
- Full Width Strap with Barrel Nuts
- Flange
- Built in Strap (Welded Barrel Nuts)
- Latch and Trunion
- None

- Standard #10-24 Screws
- Low Profile #6-32 Screws
- Heavy Duty 1/4-20 Screws
- Spring Loaded

Gap size (if required): _____

Notes:

Name _____
 Company _____
 Address _____

 Phone _____
 Fax _____
 Email _____

Termination

- Lead Wire - Specify Length: _____
- Fiberglass Leads
 - Fiberglass leads with SS Overbraid
 - Fiberglass leads with SS Armor
 - Fiberglass leads with Ex-flex Sleeve
 - Fiberglass leads with Silicone Sleeve
 - Grounded
 - Nozzle Style ("A" or "D")

Post Terminals - #10-24 thread

- Style I
- Style H
- Ceramic Terminal Covers
- Terminal Box (3" x 1.5" x 1.5" Standard)
- Custom: _____
- Ground Post

Misc:

- Euro Plug
- Euro Plug with Grounding Bracket
- Euro Plug with Housing (Straight)
- Euro Plug - Other: _____
- Hubbell Plug - P/N: _____

Holes, Cutouts, Notches

Specify Size and Location
 Drawing or Sample may be required.

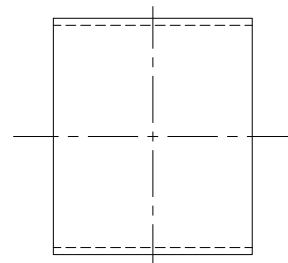
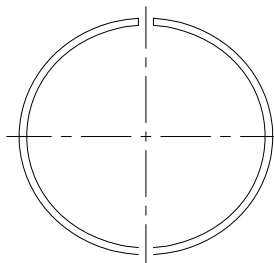

Please complete and send scanned requests to
 LHsales@lectraheat.com or fax to (513) 934-2233